

Vandal IR Dome, 18 IR (50FT), 2.0MP, H.264, ONVIF, 3.3~12mm Motorized Lens, TDN ICR, DC/AC/PoE

## EZIC-IVRM20 (18 IR - 55ft) (2.0MP)



### Features

- H.264 & MJPEG HD Network Camera
- Dual Stream
- 18 IR LEDs (50FT)
- 2MP (1080p) @ 30FPS
- Triple Power: 12VDC, 24VAC, PoE
- Analog Hybrid Output
- SDHC card slot
- Motion Triggered Alarm
- Multi Language GUI Support
- True Day & Night
- ONVIF Compliant
- 3.3~12mm Motorized Zoom
- 2D/3D DNR
- Audio In/Out

### Dimensions

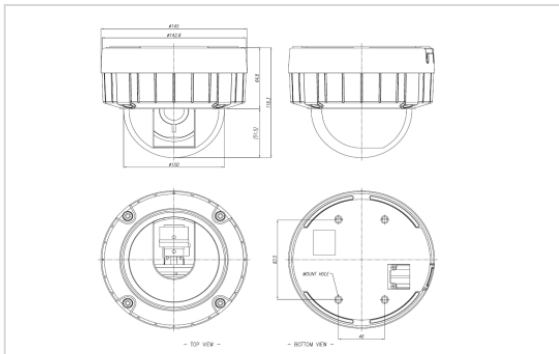

MODEL	EZIC-IVRM20		
Product Features	H.264 / MJPEG Network Camera		
	Dual Stream		
	Motion Triggered Alarm/ External Alarm In		
	Multi Language GUI support		
	ONVIF Compliant		
	Triple Power: DC12V, 24VAC, PoE(802.3af)		
	SONY CMOS Sensor IMX-122		
	On The Fly supported @ GOP/Birate/FPS setting		
	2D/3D DNR. (Depends on CODEC configuration)		
	Contrast Enhancement ( Local Exposure )		
	DPC(Defective Pixel Correction) on the fly		
	<b>IR LED 18ea / 15M</b>		
	Motorized Zoom, Focus and P-iris		
	True Day & Night		
	Analog Hybrid Output(Installation Only)		
CAMERA	<b>Image Sensor</b>	1/2.8" Sony IMX-122 CMOS Sensor	
	<b>Max. Resolution</b>	1920 x 1080	
	<b>Effective Pixels</b>	1984(H) x 1225(V)	
	<b>Effective Image Size</b>	5.56mm(H) x 3.43mm(V), 6.53mm(Diagonal)	
	<b>White Balance</b>	ATW / MANUAL (PRESET)	
	<b>Electronic Zoom</b>	2 ~ 10x(Client Software)	
	<b>AGC</b>	Yes	
	<b>BLC</b>	Yes	
	<b>Iris</b>	Motorized Iris / MANUAL / AES	
	<b>Shutter Speed</b>	1/4, 1/10, 1/12.5, 1/15, 1/20, 1/25, 1/30, 1/50, 1/60, 1/100, 1/120, 1/240, 1/480, 1/960, 1/1024, 1/2000s	
	<b>Slow Shutter</b>	2x	
	<b>Lens</b>	TAMRON Motorized Zoom and Focus lens f=3~9mm, F1.2~2.1	
	<b>Day &amp; Night</b>	Removable IR Cut Filter	
ANALOG (Installation Only)	<b>Video Signal</b>	NTSC/PAL selectable	
	<b>Monitor Output</b>	Composite Output(BNC), 75 ohm 1Vpp	
	<b>Scanning Frequency</b>	NTSC: (H) 15.734 kHz, (V) 59.94 Hz PAL: (H) 15.625 kHz, (V) 50 Hz	
AUDIO	<b>In/Out</b>	Line in, Line out External Amplifier is needed	
	<b>CODEC</b>	G.711 / 8K sampling	
NETWORK	<b>Network</b>	10BASE-T, 100BASE-TX, RJ45	
	<b>Image Compression</b>	H.264 : Base/Main/High Profile MJPEG : Image quality, 100 Steps(Q value)	
	<b>Resolution</b>	1920 x 1080(Full HD), 1280 x 1024(SXGA), 1024x768(XGA), 1280 x 720(720p), 1024x768(XGA), 1280 x 720(720p), 640 x 480(VGA), 320 x 240(QVGA), 704x480/576(4CIF), 352x240/288(CIF)	
	<b>Protocol</b>	IPv4, HTTP, UPnP, DNS, RTSP, DDNS, RTP, TCP, UDP, RTCP, DHCP, ARP, IGMP, ICMP, SMTP, NTP, HTTPS, IPv6 @ V2.0	
	<b>Frame Rate</b>	1 fps ~ 25 fps / 1 fps ~ 30 fps	
	<b>Web Browser</b>	Internet Explorer 7.0 or above Firefox Chrome PDA/Smart phone	
	<b>Security</b>	Password Protection, HTTPS @ V2.0	
	<b>SDK(API)</b>	HTML based API	
	<b>VMD(Video Motion Detection)</b>	User set 4 ROI(Region Of Interest) 10 Step Sensitivity	
	<b>Alarm Trigger</b>	VMD, External Alarm Input	
	<b>Alarm Event</b>	E-mail notification, FTP transfer, Video streaming with alarm status Pre Alarm @ V2.0	
	POWER	<b>Power Source</b>	DC12V 1.5A(Heater or IR LED) 24VAC(50Hz/60Hz) 800mA PoE(IEEE 802.3af compliant)
		<b>External I/O Terminals</b>	Alarm In x1, Alarm Out x1, Audio In x1, Audio Out x1
<b>Ambient Temperature</b>		-10°C ~ 50°C(14°F~122°F) / With Heater -30°C ~ 50°C(-22°F~122°F)	
OTHER	<b>Ambient Humidity</b>	less than 90%. Non-condensing	
	<b>Materials</b>	Aluminum Diecasting	
	<b>Dimensions(W x H x D)</b>	63.6(W) x 60.3(H) x 81.2(D) mm	

Made in Korea