

Vandal-Proof Dome, Aurora1B, 700TVL, DWDR, True D&N(ICR), HLC, 2.8~12mm, AC/DC

EVN-V750, EVN-V755

Aurora 2



Features

- 600TV lines (Color), 700TV lines (B/W) Aurora 2 DSP
- Built-in 2.8 ~ 12mm Varifocal lens with auto iris
- Powerful WDR function • Sens-Up (upto 512x)
- Wall mountable and easy adjustment with 3-Axis
- Built-in Upgraded 3D Digital Noise Reduction Technology
- Min. illumination of 0.1Lux(Color) / 0.0002Lux(Sens-up)
- True Day & Night with ICR : EVN-V755
- Eclipse function
- DIS (Digital Image Stabilization)
- Intelligent motion detection
- 24V AC / 12V DC compatible

Dimensions

(unit:mm)

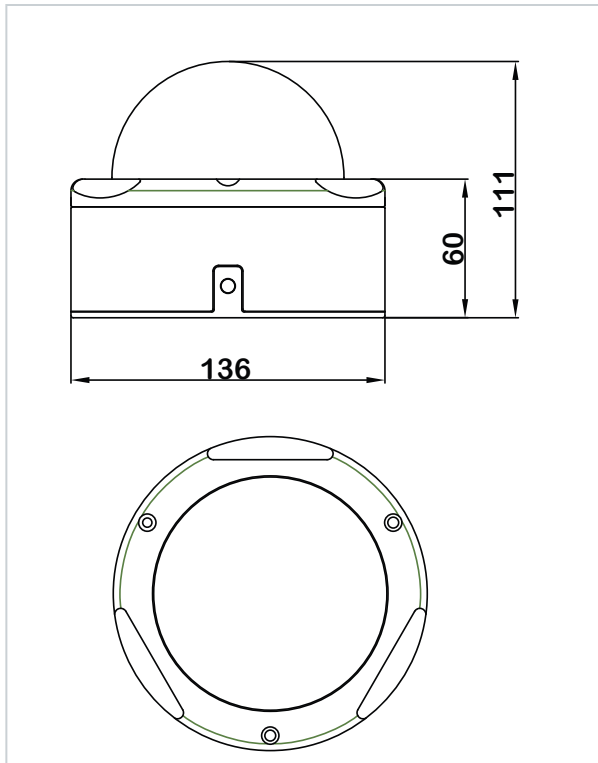

	EVN-V750	EVN-V755
VIDEO		
Aurora 2 DSP		
Image Sensor	1/3" Sony Super HAD II	
Total Pixels	811(H) x 508(V)	
Effective Pixels	768(H) x 494(V)	
Scanning System	2:1 Interlace 525 Lines / 60 Fields / 30 Frames	
Synchronization	Internal / Line lock	
Scanning Frequency	Horizontal: 15.734KHz / Vertical: 59.94Hz	
Horizontal Resolution	600TV lines (Color) / 700TV lines (B/W)	
Min. Illumination	0.1Lux / 0.0002Lux(DSS)	
S/N Ratio (Y signal)	52dB (AGC off, Weight on)	
Video Output	1.0Vp-p / 75Ω(Video 0.714Vp-p, Sync 0.286Vp-p)	
LENS		
Focal Length	2.8 ~ 12.0mm (F1.2)	
Max. Aperture Ratio	1 : 1.2 (Wide) ~ 2.1 (Tele)	
Angle Field of View (H)	81.2° ~ 22.2°	
OPERATION		
OSD	Multi-language support (English, Japanese, Spanish, Korean)	
Camera Title	On / Off	
Day & Night	Auto / Color / BW / Ext	
ICR (IR Cut Filter Removable)	N/A	YES
WDR(Wide Dynamic Range)	On / Off (WDR lever, Weight)	
Digital Zoom	On / Off selectable (1.0X ~ 10X)	
Back Light Compensation	BLC / HLC / Off	
Gain Control	Low / High / Off	
White Balance	ATW / AWC / Manual (1,800°K ~ 10,500°K)	
Electronic Shutter Speed	Auto / Normal (1/60 ~ 1/100,000) / Flickerless	
Sense-up (Frame Integration)	On / Off (2X ~ 512X)	
Super DNR	Low / Middle / High / Off selectable	
Wide Extended Range	Off / Low / Mid / High	
Motion Detection	On / Off selectable (4 Programmable zones)	
Privacy Masking	On / Off selectable (4 Programmable zones)	
Mirror / Flip	Reverse	
Sharpness	On / Off selectable (Level adjustable)	
Iris Control	DC / Video	
ENVIRONMENTAL		
Operating Temperature	-10°C ~ +50°C	
Operating Humidity	30% ~ 80% RH	
MECHANICAL		
Ingress Protection	IP 67	
Dimensions	136(W) x 111(H)mm, Ø100mm dome	
Weight	1300g	
ELECTRICAL		
Power Source	24V AC / 12V DC (±10%)	
Power Consumption	500mA / 10VA	

MADE IN KOREA